

The Friends of the Pagoda Association
PO BOX 232 MOOROOKA BRISBANE QLD 4105 AUSTRALIA

<http://www.foundationexpo88.org/friendsofthepagoda/>

The Peace Pagoda of Nepal Document
(1988)

Kindly Published to The Friends of the Pagoda Association pages at
the Foundation Expo '88 website as an historical digital record of the
Nepal Peace Pagoda, World Expo '88, and its journey to becoming one of Brisbane City's most
cherished icons

Presented and Published on the occasion of the
2nd Anniversary General Meeting of Foundation Expo '88
Sunday 30 April 2006

Keynote Speakers

Mr & Mrs Frank & Myra Pitt - the successful concluding donors of
The Save The Pagoda Committee Fund for the City of Brisbane

Cafe San Marco, South Bank Parklands
Brisbane, Australia

Please read, enjoy, and wonder at the wonderful work that has been done -
and the wonderful work yet to come -
as we celebrate World Expo '88 - Australia Nepal Friendship - and
world-wide good will
at the only Nepal Peace Pagoda in the Southern Hemisphere

A work of peace, love, fertility and harmony

With Special Thanks to

Contributors to The Save the Pagoda Committee Fund
THE AUSTRALIAN COMMONWEALTH GOVERNMENT DEPARTMENT OF FOREIGN AFFAIRS
BRISBANE CITY COUNCIL

THE BRISBANE EXPOSITIONS AND SOUTHBANK REDEVELOPMENT AUTHORITY

MR & MRS FRANK & MYRA PITT MR RAY LEWIS MR SIMON STEENLAND MR TONY BISHOP
MS RITA HUBBARD MS VALMAE EDWARDS MR WARREN HYNE

Led by The Save the Pagoda Committee

ALDERMAN DAVID HINCHLIFFE MR DONALD SPENCER MS CYNTHIA OATT
MR DES RITCHIE MR RON STANTON MR AMRIT SAKYA

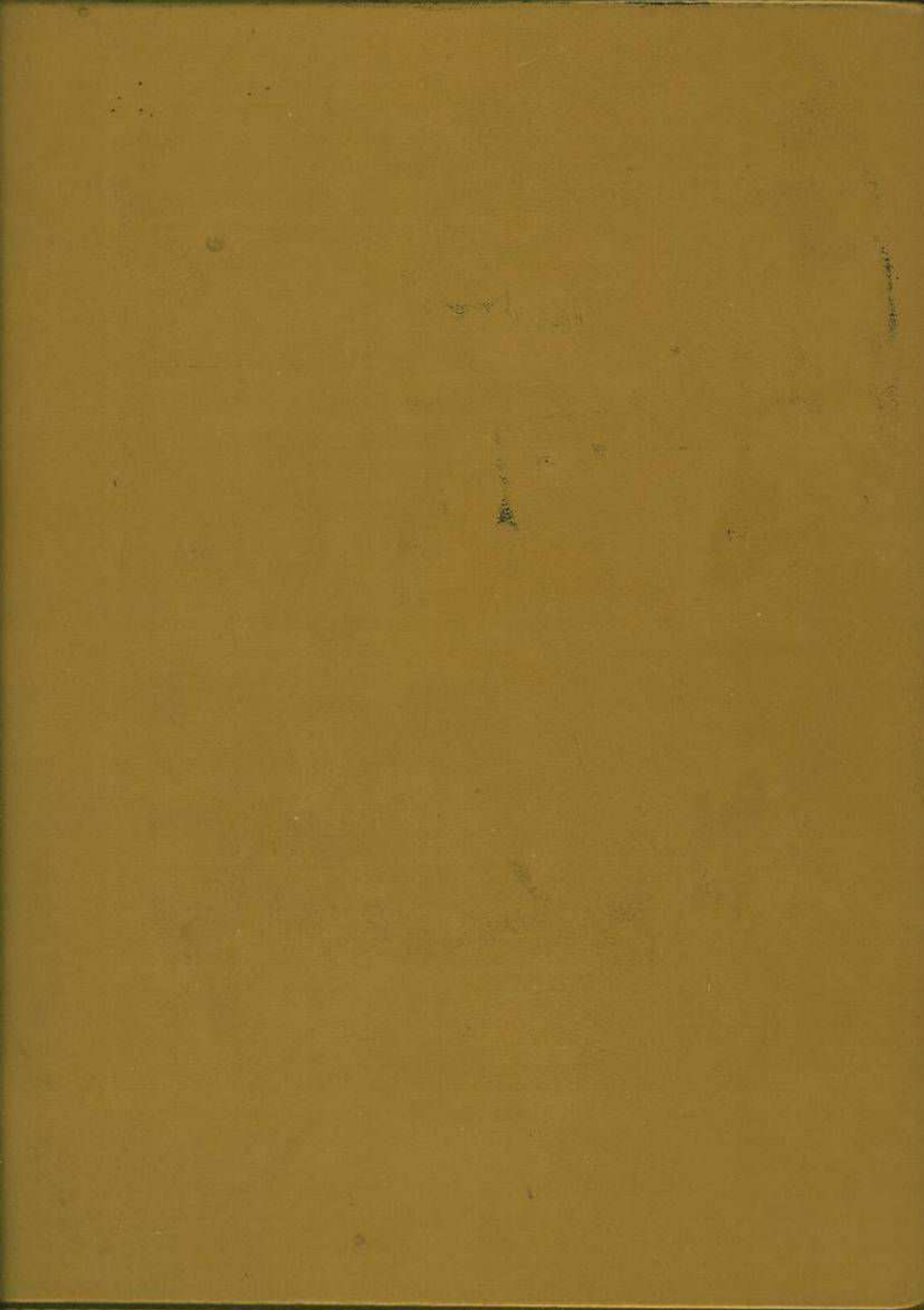

The
PEACE
PAGODA
of
NEPAL

THIS PROJECT HAS BEEN DEDICATED TO
WORLD PEACE
AND
THE PEOPLE OF NEPAL



One of the imposing statues guarding the
entrance to the Pagoda.

(There are four such guards)

1. INTRODUCTION

Thousands of people have said (and written) that the Peace Pagoda of Nepal has been the most wonderful object they have seen at World Expo '88 in Brisbane - the catalyst of wonders in the modern world.

More than one thousand Pagodas stand inside Nepal but only one other outside - at Munich in West Germany.

Both Pagodas outside Nepal have been constructed and erected by the people of Nepal under the guidance of the Association to Preserve Asian Culture - APAC.

This manual is written with the purpose of retaining the Peace Pagoda in Australia.

It will be a symbol of Peace for a thousand years.

It will also make the purchaser a fundamental contributor to the two thousand years old cultural heritage of Nepal and the owner of an architectural masterpiece.



THE GROUND FLOOR SHOWING SOME OF THE
INTRICATE CARVING

2. BRIEF HISTORY OF THE PROJECT

Nepal was only declared open to the world in 1951. Before this time the ancient craftsmanship was handed down through the generations. Now, unfortunately, like most countries of the East, the land once known as the valley of the artist is losing ground to modern technology.

The Peace Pagoda will hopefully alert modern men and women to the priceless art and craftsmanship which we are surely losing if the modern trend continues.

APAC management believes that this art can be sold outside Nepal thus maintaining a better standard of living through "Trade not Aid".

During the International Year of Peace (1986), His Majesty's government of Nepal announced its' participation in Expo '88 and piece by piece the timber of Terai in Southern Nepal were dragged to Kathmandu. There, 160 families worked for more than one million hours creating this masterpiece.

It was loaded into three containers and brought to World Expo '88 via Calcutta in India. There, with the assistance of World Expo '88 authority, it was erected.

3. BRIEF HISTORY OF PAGODAS IN NEPAL

The capital of Nepal - Kathmandu valley - is a living museum without walls. There are more than 3000 temples and shrines, built since 4th century A.D. to represent peace, harmony, eternity and fertility. Nepal is one of the very few countries in the world where two religions - Hinduism and Buddhism - have co-existed with the greatest harmony. Not a single religious conflict has occurred in this peaceful country. Nepal has a very deep-rooted cultural heritage reflected in its' Pagoda architecture. A masterpiece of art, the Nepalese Pagoda, has continued to transmit examples of the rich traditional craftsmanship of woodcarving and brassworking.

Each carving of wood and each working of brass symbolises fertility, eternity and peace.

The Pagodas of Nepal are used as rest houses, meditation houses, centres for religious observance and cultural centres.

In Sanskrit they are known as "Mandap".



ONE CORNER ON THE OUTSIDE.

(ALL FOUR CORNERS OF THE PAGODA HAVE
THIS SUPERB CARVING)

4. TRADITIONAL JOINERY

In keeping with the aims of the project, APAC management took meticulous care to ensure that the joinery used in the assembly of the Pagoda represents traditional woodworking techniques in Nepal.

Post and beam (mortise and tenon) techniques secured by dowels have been employed throughout. All horizontal beams are half lapped except where structural necessities deemed otherwise. Coach bolts or continuous bolts were used where calculation so required. Their use for easy disassembly post Expo was a consideration.

All screenwork used in the Pagoda is half lapped and hand carved.



Traditional Join: a hand chiseled interlocking joint with wedge for longitudinal joining of strut purlin adapted for strength in compression and tension. A singing bell hangs above.

5. BRASSWORK AND ORNAMENTATION

Of utmost importance for the Pagoda architecture of Nepal is the use of brass and/or gold plated copper as a sign of wealth and generosity or adornment. All roof sheathing is of 0.6 mm brass and the ornamental brasswork at the eaves is genuinely handbeaten on moulds according to ancient techniques used in the Kathmandu valley.

The roof peak is crowned by a gold plated copper gajur and a brass plated pedestal. A patta (or Jacobs ladder) of hand beaten brass plates joined together is in the middle roof axis.

The use of singing bells under the eaves is traditional for temple architecture and symbolises duality in life, action and reaction. Each singing bell is made of an alloy of seven metals from an individual wax mould so no two bells are exactly alike. Nepal is one of the very few countries in the world which practice this wax mould process for metal casting.



The front door showing some of the painstaking
carving

(All six doors are of similar craftsmanship)

6. TIMBERS

The three species of Nepalese timber used in the construction of the Nepalese Peace Pagoda are as follows:-

1. *Shorea robusta* (common name: Saal wood) used for its straight grain which is extremely dense. The inner four vertical columns which have a continuous length of 8.5 metres serve as the main structural bracing timbers. All horizontal beams in the roof section are of Saal as well as the floor bearing beams in the first and second floors. The perimeter ring beams (interlocked) are also of Saal. Saal has a weight of 881 kg / m at 12 percent moisture content with high durability to weather and high refractoriness to air seasoning.
2. *Dalbergia Sisso Roxb.* (common name: Sisso wood) used for its lively grain and excellent properties for carving. Virtually all carved elements in the Pagoda are of Sisso wood. Outside columns, doors, roof struts, five - parts ring beams etc. Sisso has a density of 785 kg/m, is very hard with moderate durability which has been increased by treatment with sealants.
3. Asna wood used for ceiling cassettes (tongue and groove) and hardwood flooring in first floor. Rich in colour and scuff resistant treated with wax.



THE FIRST FLOOR OR TEA ROOM AGAIN
SHOWING SOME OF THE EXQUISITE
CARVING

8. DISMANTLING

The carpenters who erected the Pagoda on its present site all live in Brisbane and could possibly be re-employed to dismantle it.

All pieces would be numbered before movement.

An estimate of the manpower and other costs involved is as follows:-

4 men for six weeks working	
40 hours per week @ \$15 per hour	\$14,400
Management 50 days @ \$120 per day	\$ 6,000
Crane hire for 12 days	\$ 6,000
Compressor hire for 6 days	\$ 2,000
Scaffold hire for 4 weeks	\$ 3,000
Machine, tools etc.	\$ 1,000
Miscellaneous costs	\$ 7,000

TOTAL DISMANTLING COSTS	\$39,400

9. TRANSPORTATION

As the Pagoda was dismantled it would be packed into three shipping containers :

- 1 - 40' container (topless)
- 2 - 20' container (topless)

The small Pagodas would be shipped "as is" on a flat truck.

An estimate of transportation costs is as follows :

1 - 40' container for 6 weeks	=	\$ 1,200
2 - 20' container for 3 weeks	=	\$ 1,200
Transporting these containers to their destination	=	\$ 2,000
Transporting small Pagodas	=	\$ 2,000
Transporting Bricks, tiles, steel grid etc	=	\$ 2,000

		\$ 8,400

10. RE - ERECTION

The Pagoda would be re-erected on its steel grid which in turn rests on a 200mm concrete slab.

An estimate of associated costs would be as follows :

Labour	4 Men for 12 weeks 40 hrs/week @ \$15 per hour	\$ 28,800
Management	84 days @ \$120 per day	\$ 10,080
Crane, Compressor, Scaffolding Tools etc		\$ 16,000
Concrete Slab		\$ 9,800
New materials (plywood, brass, screws etc)		\$ 6,000

		\$70,680

11. ESTIMATE OF TOTAL MOVEMENT COSTS

An estimate of all costs associated with moving the Pagoda is therefore as follows:-

Dismantling	\$39,400
Transportation	\$ 8,400
Re-erection	<u>\$70,680</u>
	<u>\$118,480</u>

12. AVAILABLE OPTIONS FOR THE PAGODA AT PRESENT

In 1984 it was planned that the Peace Pagoda would be sited beside the Brisbane river and used as a Tea House or Cultural Centre after Expo '88. The same plan has been used for the first Pagoda very successfully in Munich Germany. If the re-development plans for the Expo site did not incorporate such siting then the Pagoda could be floated down river to the Botanical gardens and serve as a Tea House for the citizens of Brisbane.

A steel grid has been established underneath the Pagoda for stabilizing purposes during the operation.

However as World Expo '88 unfolded and other contingencies took precedence the Pagoda turned out to be well away from the river.

Four options are now available:

1. Retain the Peace Pagoda on its present siting and use it as a Tourist attraction/Tea House/Meditation house/Restaurant/Cultural Centre/Exhibition house etc.
2. Pull the Pagoda on steel rails to the river bank and use it as above (this operation will be possible after the mono-rail is dismantled).
3. Pull the Pagoda to the river bank and float it down river on barges to the Botanical gardens as originally suggested.
4. Dismantle the Pagoda and pack it into three shipping containers and ship it anywhere in Australia or overseas.

13. INVESTMENT PLAN

The craftsmen of Nepal together with the APAC management team have invested more than one million man hours felling, carving, measuring, cutting and erecting the Pagoda for World Expo '88.

Together with the returns of selling food at Expo we feel everybody would receive an adequate compensation if the Pagoda was sold for \$577,000 a statement of the hours, materials and management investment, inherent in the Pagoda, is included in the addendum.

All bells statues and fixtures is included in the Pagoda. For the purchaser of the Pagoda, the investment would be as follows:

Pagoda + Sano Pagodas	\$577,000
Dismantling, Transportation and re-erection	\$118,480
TOTAL INVESTMENT	\$695,480

14. TAX CONCESSIONS

If a company or consortium purchases the Pagoda and donates it to a Cultural or Educational body, then, provided the recipient is an approved donee for the purposes of section 78 (1) (a) of the Income Tax Assessment Act, a deduction for the amount paid would be allowable for income tax purposes provided the Pagoda was donated within a period of 12 months of acquisition.

A deduction under section 51 (1) of the Act (the general business deduction provision) may also be a possibility if the donation can be shown to be in the form of advertising etc.

Given the present company tax rate of 39 cents in the dollar, the after tax cost to the company would be 61 cents in the dollar.

Because of the higher marginal tax rate for individuals, the after tax cost to an individual would be approximately 50 cents in the dollar!

15. A P P R E C I A T I O N

Sincere thanks must be expressed to the following Institutions and peoples without whose help this project would not have been possible :

1. His Majesty's Government of Nepal for their encouragement, assistance and moral support at the outset and throughout this project.
2. The World Expo '88 authority for their vision, financial assistance in establishing the site and making Expo an enjoyable and heart warming place to be.
3. The Nepalese artisans and craftsman for their exquisite craftsmanship, skill and deep rooted feeling. Their participation was generous and expressed with good humor.
4. The wonderful visitors to Expo who expressed their appreciation loud and clear every day over the last months.
5. The World Expo Volunteers for their unlimited efforts, good humor and commitment to Peace & Harmony.

Signed :

DEAN RICKER DIPL. ING. ARCH.
TECHNICAL SUPERVISOR, APAC.

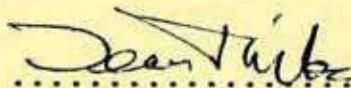
.....

AMRIT SAKYA M. AGR. ENG.
CULTURAL ADVISOR TO APAC
AND CONSULTANT TO NEPAL NATIONAL COMMITTEE.

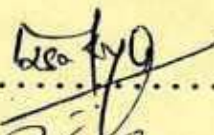

DES RITCHEE M.A. B.COMM.
BUSINESS CONSULTANT TO APAC.

.....



One of the two small or 'sano' Pagoda



The bell of Peace, standing in front of
the Main Pagoda

(Two such bells belong to the Peace Pagoda)

A D D E N D U M

A) MAIN PAGODA PLANS

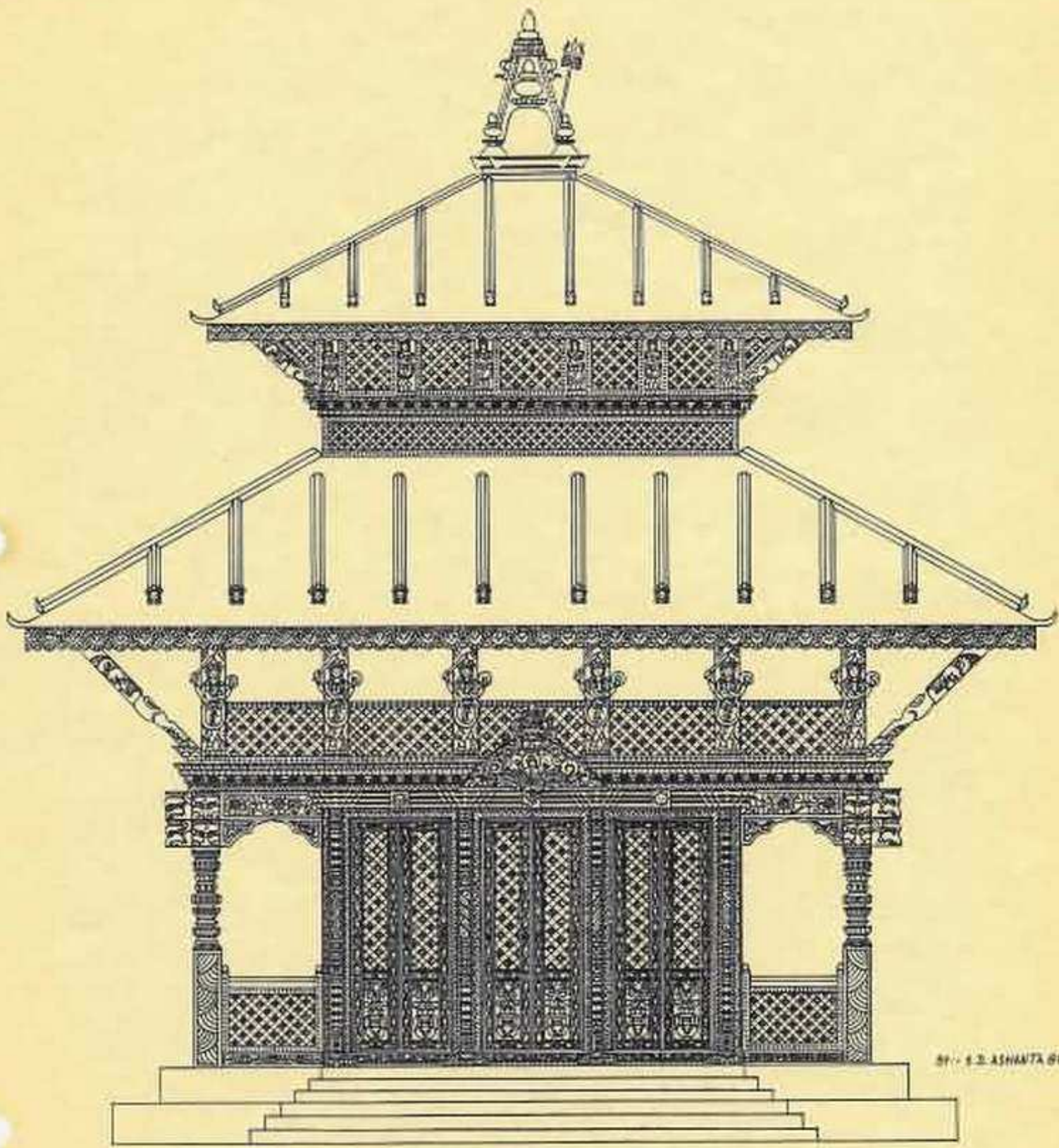

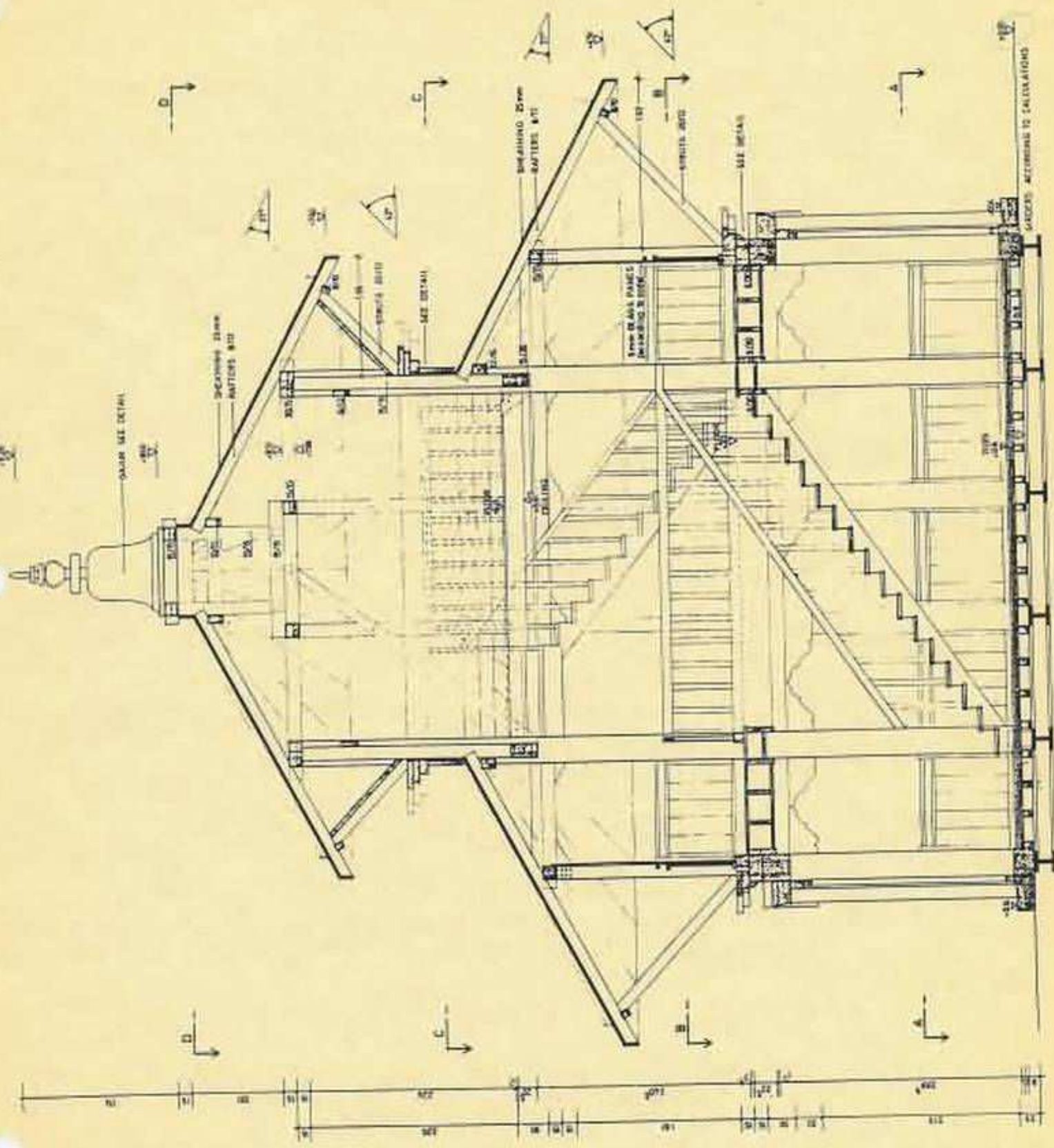

WOODEN ROOFING
WOODEN WALLS
WOODEN FLOORING
WOODEN JOISTS

WOODEN JOISTS
WOODEN FLOORING
WOODEN WALLS
WOODEN ROOFING

WOODEN ROOFING
WOODEN WALLS
WOODEN FLOORING
WOODEN JOISTS

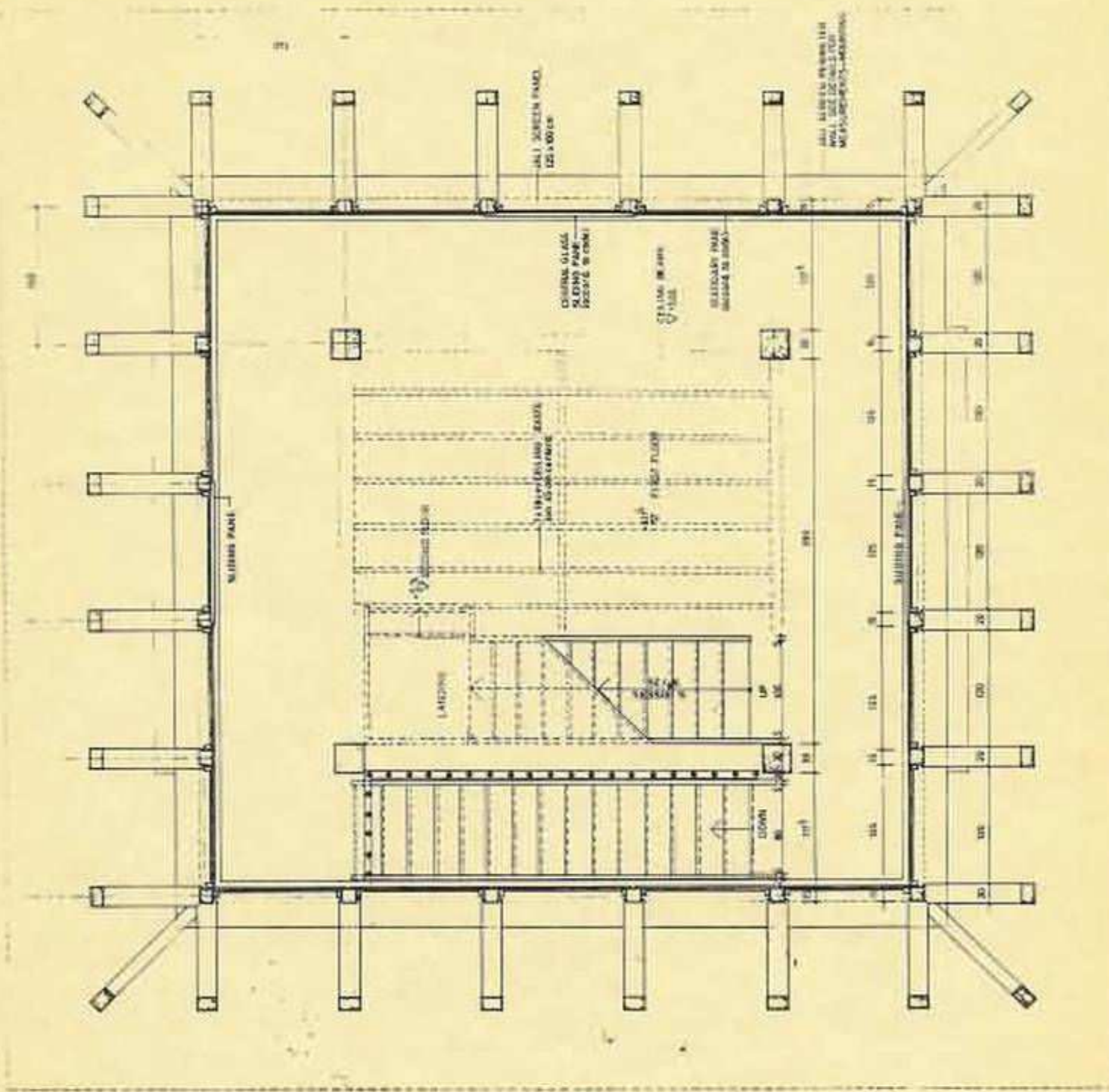

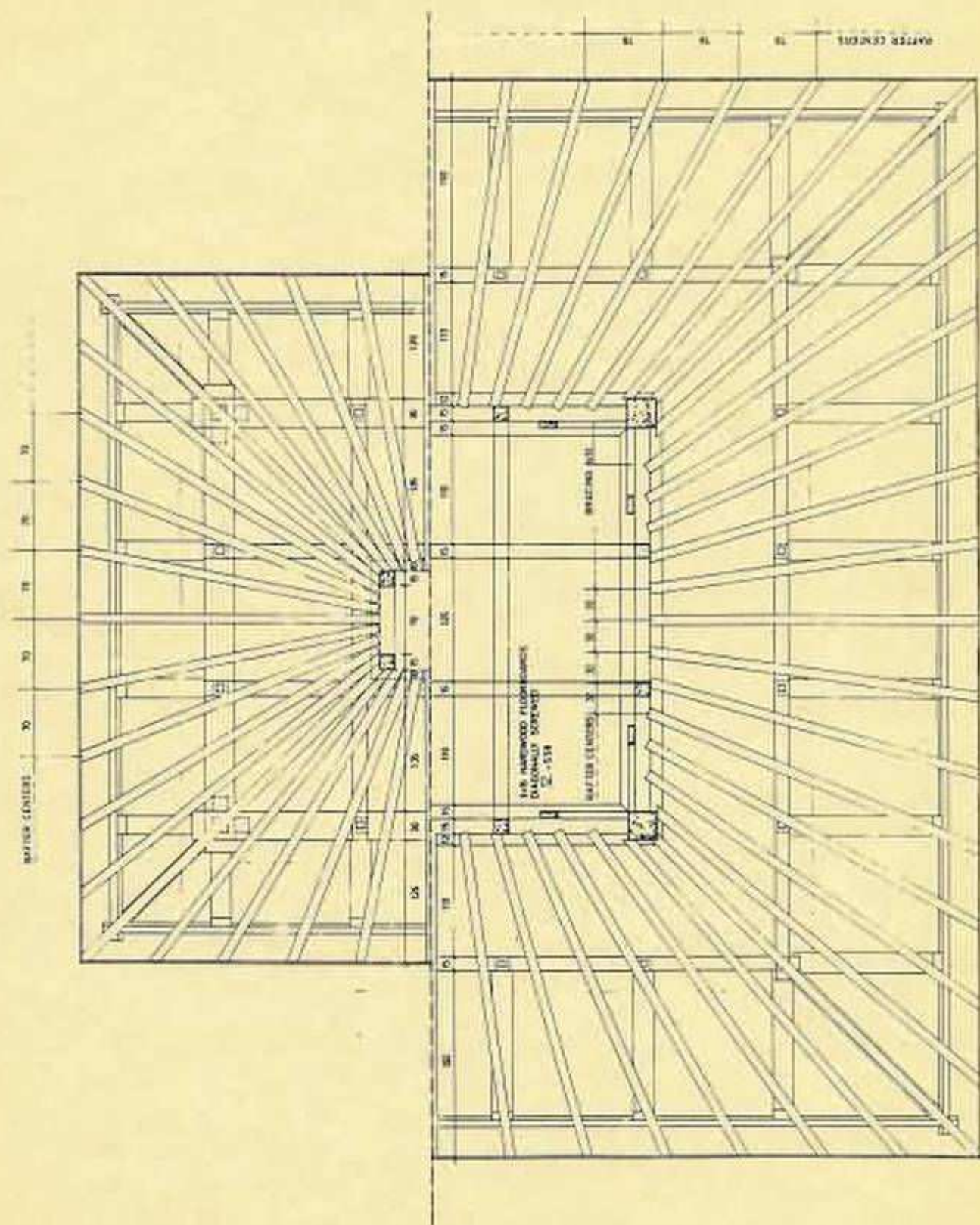

RAFTER CENTERS

JOIST CENTERS

1 1/2" HARDWOOD FLOOR JOISTS
 DIAGONALLY NOTCHED
 S. - 514

RAFTER CENTERS

JOIST CENTERS

B) SANO PAGODA PLANS



WORLD EXPO 88
BRISBANE-AUSTRALIA
-SANO PAGODA-

SECTION 1:10

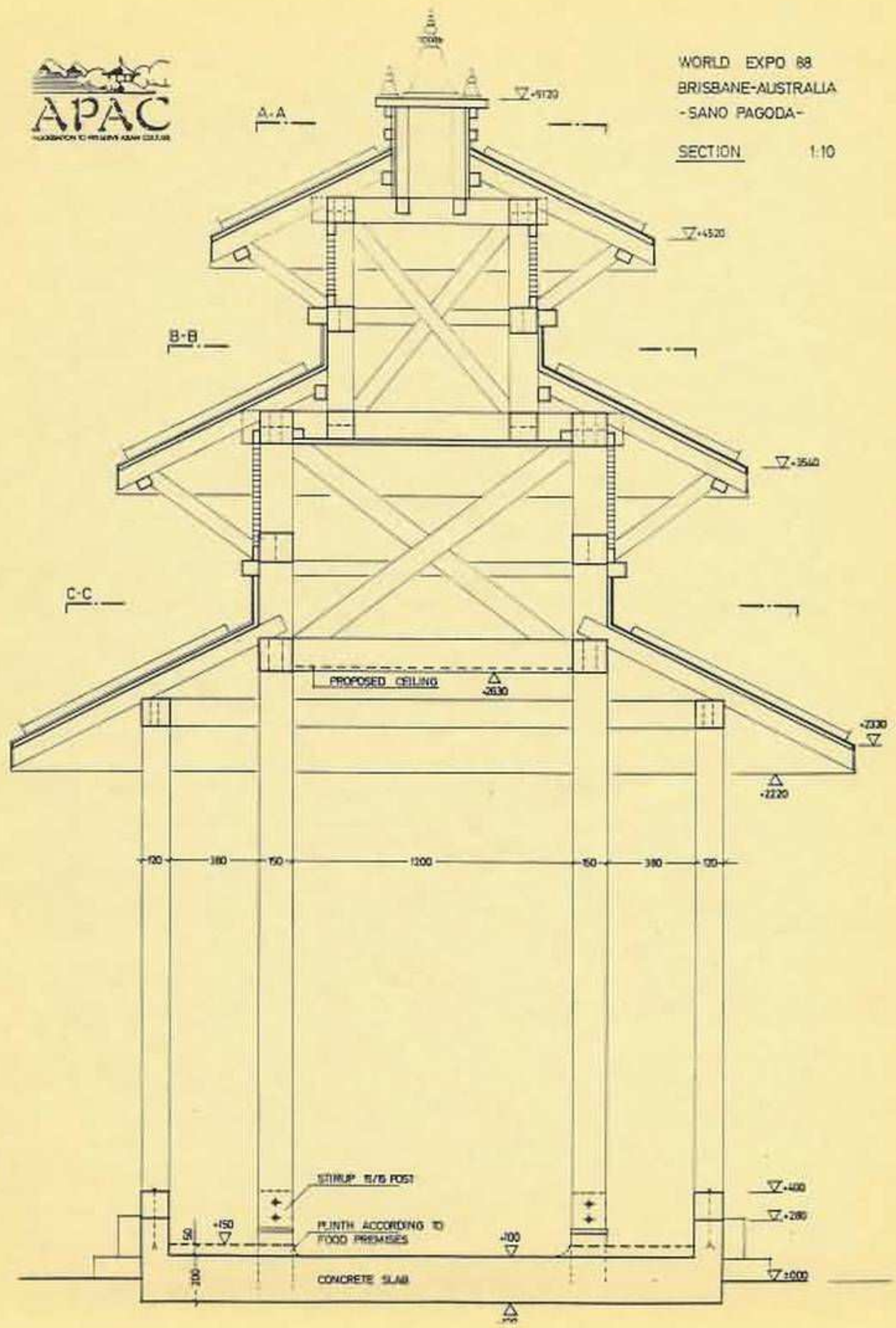

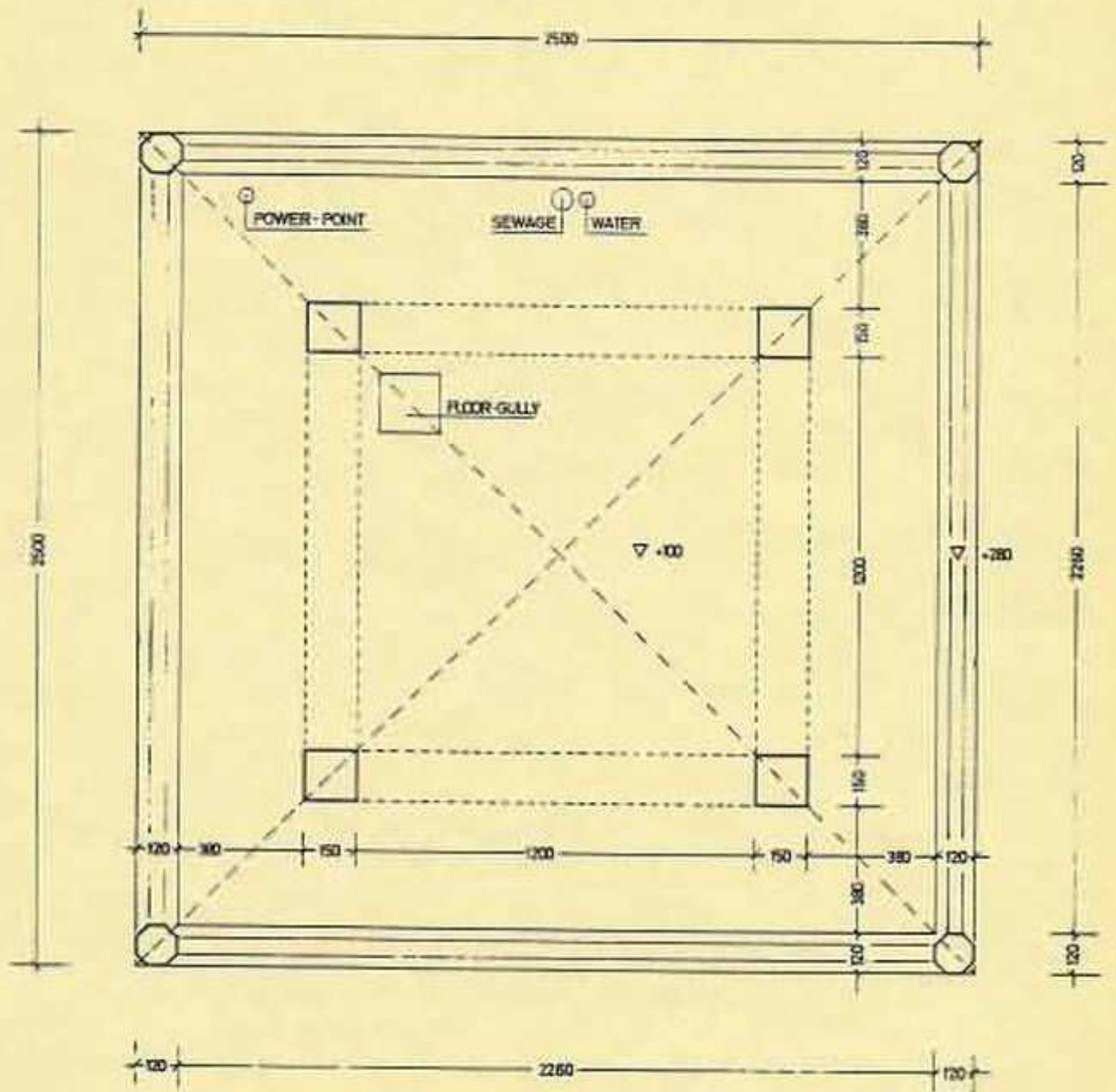

FOUNDATION DETAIL SCALE 1:1

ROOF MEASUREMENTS IN CM

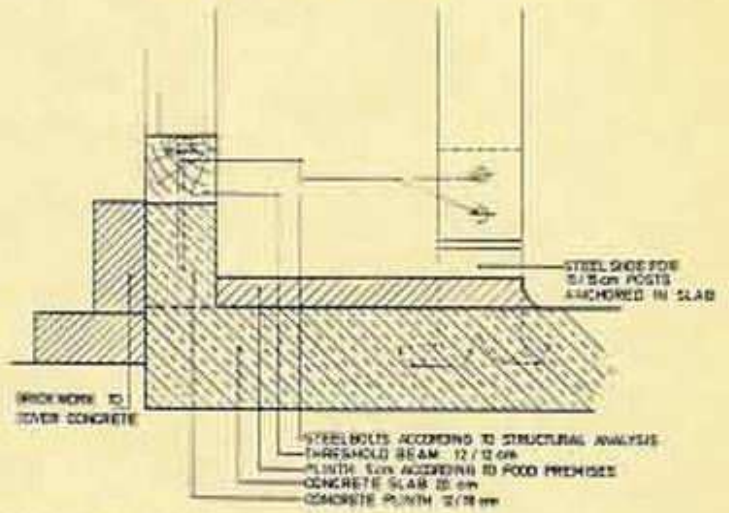
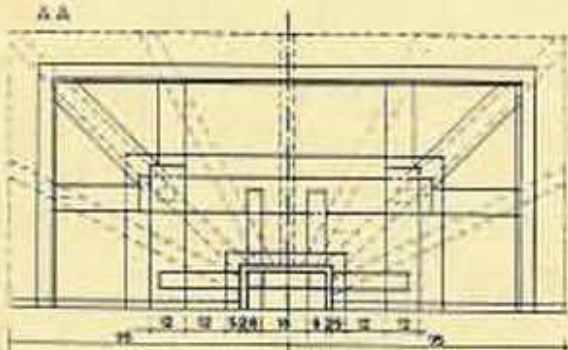

BB

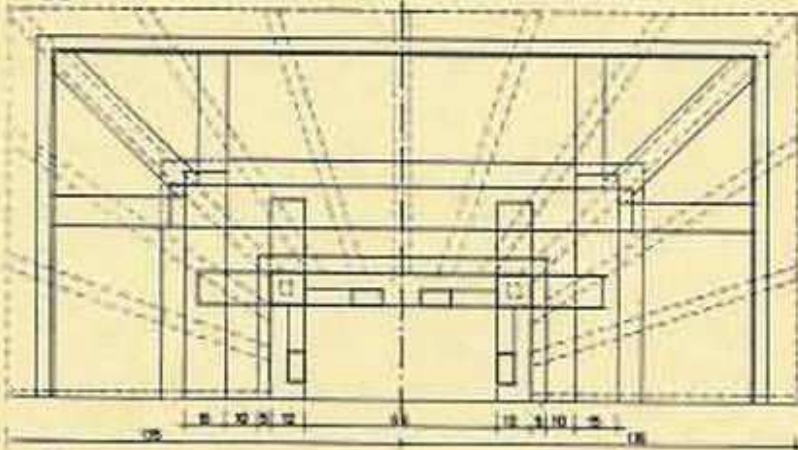

FOOTNOTE:

- ALL DETAILS REGARDING FASTENING OF SCRUTS + RAFTERS SEE LARGE PAVODA
- SHEATHING SCREWED TO RAFTERS
- OUTSIDE DIMENSION CONCRETE SLAB 150 x 150mm
- 4 STEEL SHOES IMBEDDED IN CONCRETE SLAB FOR FLAG ON POSTS ON 16m CENTERS AS FOLLOWS

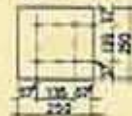

CC

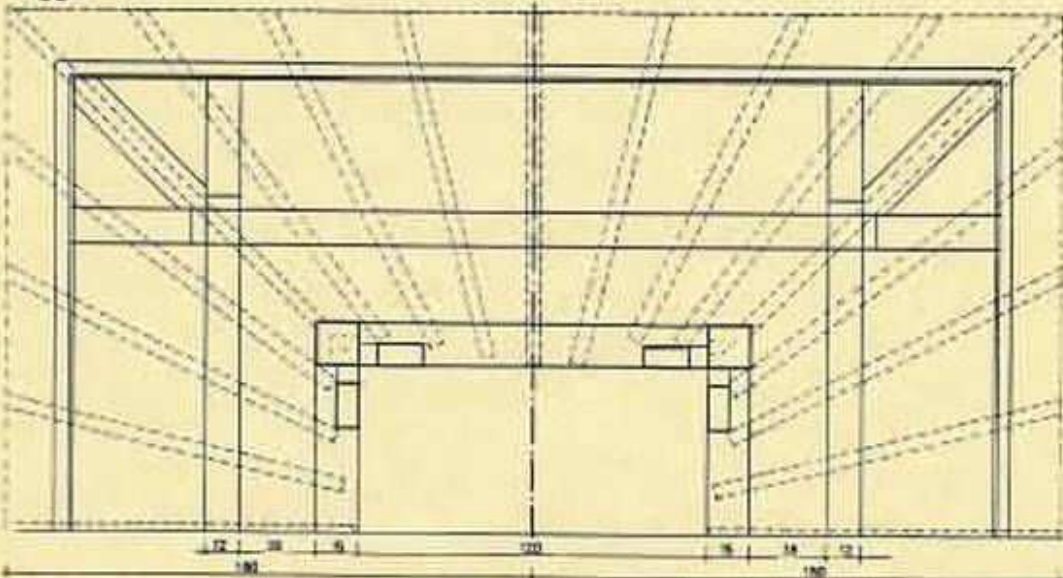

C) OTHER ENGINEERING DATA

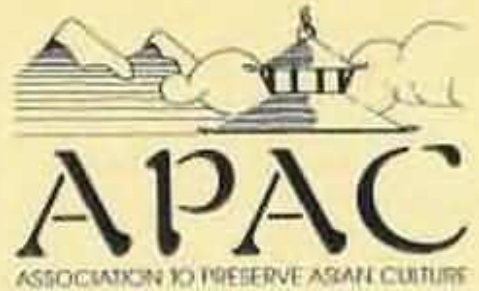

APPROVAL NUMBER

.....

WORLD EXPO '88 BUILDING CONTROL CODE

STRUCTURAL CERTIFICATION

DESIGN CERTIFICATE (see notes)

3B(I)

1. I/We* being ~~XXX~~* practising structural engineer(s)* within the meaning of the World Expo '88 Building Control Code or other person or body (where a person or body other than a practising structural engineer is proposed to certify the structural design of the proposed building work, a separate submission detailing the person's or body's qualifications and experience relative to the building work concerned shall be submitted for approval of the Expo '88 Building Control Office) hereby certify that:

2. I/We ~~XXX~~/are* responsible for the structural design of the building work described as:-

.2 Storey Timber Structure.....

Applicant .. Association to Preserve Asian Culture (APAC).....

Site Location

Building Zone	Building No.	Grid Reference		Level No.
		N	E	
15	K132	1160	960	

Building Name .. Nepalese Temple.....

Shown on Drawings No. K132 SS.001/002, APAC Plan No's. 1, 2, 3, 4a

3. I/We* certify that the abovementioned building work has been designed in accordance with the principles of structural mechanics to sustain the most adverse combinations of loads to which it will be subjected in accordance with the relevant provisions of the World Expo '88 Building Control Code.

The relevant Australian Standard Codes, Specifications and References relied upon in the design of the building work are as follows:

AS1170	Minimum Design Loads on Structures -
	Part 1 Dead and Live Loads
	Part 2 Wind Forces

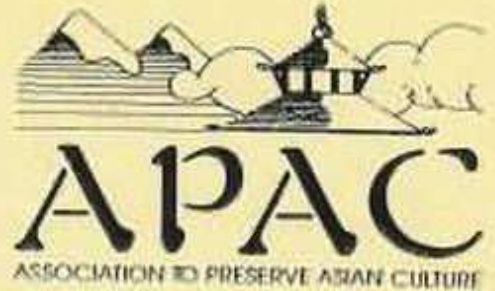

- AS1250 The Use of Steel in Structures
- AS1480 The Use of Reinforced Concrete in Structures
- AS1640 Rules for Brickwork in Buildings (metric units)*

.....

If the design does not comply fully with the relevant Australian Standard codes, state in which areas it differs

.....

.....

.....
(Attach reports if necessary)

4. The basic design criteria and assumptions used in the designs are:

(a) Wind Design

- terrain category. 1,5.....
- cyclone or non-cyclone. non-cyclone.....
- design wind velocity. 50 m/s.....
- internal pressure co-efficients. -0.3 or +0.0....
- any special topographic feature.....
-

(b) Footings and Foundations

- foundation classification. stable.....
(eg reactive or stable soils, rock etc.)
- method of foundation assessment. Geological Investigation
- design bearing pressure. N/A.....
(if applicable - not generally required for low rise structures)
- other relevant information.....
(eg filled sites, possible erosion or undermining of footings etc.)

D) INHERANT INVESTMENT IN
THE PAGODA

INHERANT INVESTMENT IN NEPALESE PEACE PAGODA

1.	ARCHITECTURAL PLANNING, DOCUMENTATION 1985-1988 IN NEPAL/GERMANY/AUSTRALIA	\$42,000
2.	ADMINISTRATION COSTS IN NEPAL/GERMANY 1986-1988	\$55,000
3.	DRAWING ACCOUNTS FOR 4 EXECUTIVES FROM 1984-1988 WORKING IN NEPAL, WEST GERMANY AND AUSTRALIA	\$62,000
4.	WOODCARVING OF 80 TONS OF TIMBER BY 160 FAMILIES FOR ONE & HALF YEAR 1986-1987 (APPROX. 1 MILLION WORKING HOURS)	\$160,000
5.	BRASSWORK, STONWORK ETC.	\$35,000
6.	TRANSPORTATION OF TIMBER FROM JUNGLE TO WOODCARVING FAMILIES IN KATHMANDU VALLEY	\$18,000
7.	TRANSPORTATION COSTS OF TEMPLE FROM KATHMANDU TO CALCUTTA BY CONTAINERS AND THEN TO BRISBANE BY SHIP	\$49,000
8.	ERECTION COST EXPO SITE	\$60,000
9.	INTERESTS PAYABLE ON PROGRESSIVE LOANS (20%) FROM 1985-1988.	\$96,000
	TOTAL -	\$577,000

E) SOME COMMENTS FROM THE PEOPLE OF BRISBANE

Seven books are already filled with comments and signatures by the visitors to the Peace Pagoda.

More than 70,000 people will have commented upon and expressed a view that the Pagoda should be retained in Australia after World Expo '88 is ended.

Some copies of these comments are contained in the following pages.

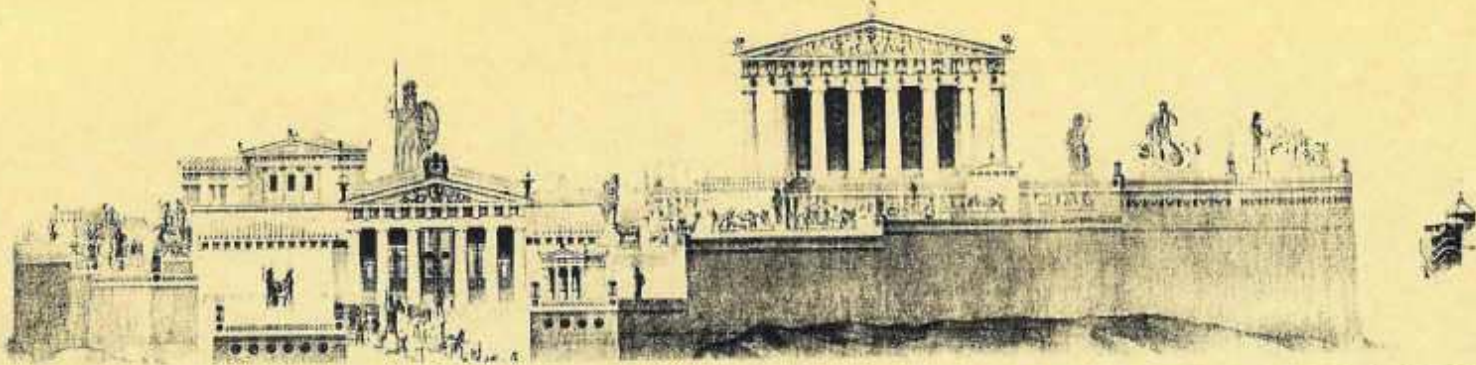

RUSSELL HALL ARCHITECTS

RUSSELL HALL ARCHITECTS PTY LTD • DIRECTORS: RUSSELL HALL DIP ARCH ARAIA • FREDIANO IEZZI B ARCH ARAIA

27th September, 1988.

Peace Pagoda Petition,
Post Office Box 2013,
SOUTH BRISBANE. 4101

Dear Savers of the Nepalese Pavilion,

I write to give my support to you in your endeavours to maintain the Nepalese Pavilion in Brisbane.

This most beautiful work should be kept at all costs. Whilst I whole-heartedly agree with your endeavours, I think that a far superior site could be had to display this building than the present position at the Expo site.

Its present use as a type of tea house seems to be most appropriate and because of this a Botanical Gardens' site or something similar in that type of landscape, maybe beside a lake would reveal its beauty to greater degree, than the present mish mash of surrounding items which it is in at the present time.

Hopefully this letter of support is of some use to you in endeavours.

Yours faithfully,
RUSSELL HALL ARCHITECTS PTY. LTD.

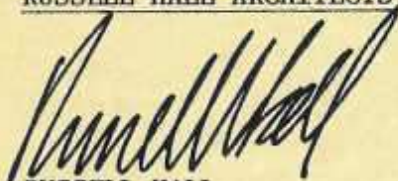
RUSSELL HALL

Vida Coleman	Kennan 4069	Shobane needs this paper!
C Kempnich	Enoggera 4051	Just because its made wood there's no need to knock it down, even though its Old of course.
V Moore	Anninley	Of course.
C WEBSTER	CAPALABA	Keep it forever.
Lisa Webster	Capalaba	Keep it forever
D WEBSTER	"	"
B Hartley	NEW ZEALAND	Keep it forever!
S Hartley	NEW ZEALAND	Frankful Paulians
J. Bessop	Sunshine Coast	PEACE everywhere
R. M. Kinnaird	Wallingong	Yes.
P. SCARF	Northgate 4013	keep it.
TRINA SMITH	UNITED KINGDOM	KEEP THIS PIECE OF HISTORY WITH ME IN AUSSIE!
PETER SCARF	BRISBANE	YES PEACE IS NEAR! IN A QUIET MOMENT IN A MOMENT OF TIME
HOWARD PHOENIX	BRISBANE - 02.	KEEP
SPENCER KEY	New Zealand	wonderful
R. MOORE	BRISBANE	great
J. apt	Tumbalong	
M. Scarf	BRISBANE	} Super B.
R. Scarf	BRISBANE	Keep it Its beautiful
V Paul	Brisbane	
C. Adams	Caloundra	
A. Allen	Cudgen, N.S.W.	yes. keep it!!
M. Ferran	Brisbane	wonderful!! 133
V MOORE	BRISBANE	PEACEFUL
J. Moore	W. Liff	Exactly as it says Simple of Peace
R. Jackson	Kingston	Very interesting (keep it!)
S. JACKSON	Kingston	FOR leave it here
A. CAMPBELL	BOONDA

20-7-1928

Laurie Bowen

Ballina

x x x

Lorale F Clayton
Kate Hockmire
A Meyer
Phillip McDick
Dee Sanderson
Ray - Joy Sutherland
Pat Collins
Robina Christie
Terence Ross
M.K. Vandenberg
Melita Clifford

Enfield
Canberra
Brisbane
Tamworth
Perth
Barronville WA
Auckland NZ
Geelong
Hokitika NZ
Mandabulara Q.
Casino

Enchanting. x x x x
Peace - Quiet!
Very interesting
Great.

Jenny Don
Donna Blanford
Gandy McLean
Helen Davis
R.J. Saxon
Kathy Kowacki
Patricia Lunn
Sandra Wolfgang
Robin Wolfgang
Gayle Edgall
Mara Barton
William & Meta Clark
David Wood
Dot Wood

Redcliffe
Gold Coast
Gold Coast QLD
Gold Coast QLD
Brower NSW
Sydney NSW
Brisbane
Denison NSW
Denison NSW
Wollongong NSW
Wollongong NSW
Stadstone
Orbit Kidder
Barraba

Unusually fantastic
Peace -
lovely.
Great!
Fantastic.
Peace!

Mystical
speechless!
Beautiful
PEACE FULL
Woodwork beautiful
" "

The Main Man
The Main boy
Geg Hunt

Sydney
Barraba

Incredible Beauty
M Moore
Jane Daniel
Celia Miller
T. Edwards
Dorothy Baxter

Sydney
Barraba
Tasmania
Warran.
CRANFORD NSW
Bendalong.

Wollongong
Excellent
Scene
Wonderful
Inhabiting
Peace

A beautiful
peaceful
Beautiful
A good
BETTER

Strandl Dubois
 am Jacques
 KELLY Jacques
 ANDREW Jacques

HELEN OLSEN
 RHEANDA OLSEN
 Graham Haller
 Vilene Hadden
 Betty Reid
 EUGEN JAMES
 O'NEIL

REAGAN SHERWOOD
 Chris Cocks
 REA SHERWOOD (TONKA)
 A. McElrea
 A. McElrea
 I. McElrea

ROBERTS
 Carl Romano
 Sheryl
 B. Reubel
 D. Reynolds
 Rhona
 H. Elliot
 M. Allen

C. Bateman
 C. Baker
 Blaine Baker
 M. Kelly
 Glen Kelly
 A. Gibbons

LOAN DUNBAR
 CLARA GOTT
 MA BERRY
 T. JACKSON
 D. BRANDON
 K. WATSON
 P. NEIL

Brisbane
 Brisbane
 "

Roma QLD
 ROMA QLD
 Morningside Qld.
 Brisbane

Brisbane
 BRISBANE
 Sydney

Blackwater
 Mapleton.

BLACKWATER
 Brisbane
 Brisbane
 Brisbane

Brisbane
 Brisbane
 Brisbane
 Gladstone
 Brisbane
 Burleigh
 Brisbane
 Brisbane

Lowood
 Inwood
 Grandchester
 Grandchester
 Sydney

TRICKY, BRISBANE
 Malaysia
 Brisbane
 TOWONG

REDLAND BAY
 VIC
 BRISBANE

Good
 leave it here
 LEAVE IT HERE
 WRITE IT IS
 VERY GOOD
 GREAT

Very Good - Perfect.
 Please keep it here
 "symbol of peace"

Good
 - All I can
 keep it here
 Yes, do beautiful
 Good. KEEP IT HERE
 Keep it!! Or Else
 Keep it here
 Keep it here
 Must be kept
 to be kept here.
 to be kept here for
 you

Please
 Please keep it here.
 a new Symbol of Peace

Good
 Good
 Keep it here
 Please keep it here
 " " " "

VERY IMPRESSING!
 PEACE PLEASE!
 CHOICE
 MARLY

I LOVE TIMBER PLEASE
 KEEP IT
 GREAT!!!
 ANALYZING???

John Daley Melbourne The pagoda affirms values about people and personality. It is the most important exhibit at Expo

Carl Lanning Germany Dies is the ultimate and noblest (and only) of Expo. It is held in the Alps

Frankie Lynch Tallinn, Estonia Keep it here.

Ellie Nashen Malaysia love the long and poultry

Wanda Piper Tasmania yes it's such a peaceful building

John Hester Brisbane yes it's a beautiful symbol of peace

John Hester Brisbane yes please, do keep it here!

John Hester Brisbane yes, a place of peace, beauty, and joy

John Hester Brisbane Great! Right!

John Hester Brisbane Great! It's a great piece of art

John Hester Brisbane yes, incredible workmanship

John Hester Brisbane We should all put down our swords pick up a flower keep this gem here

Wendy Savage Yes, it is magnificent

YES A Reminder of Expo

